

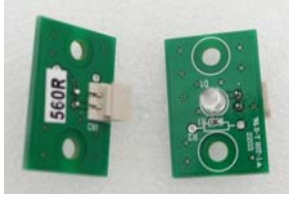

HOW TO REPLACE SOCCER SAFARI SENSOR

[CONTENTS]

1. PART LIST	P01
2. HOW TO REPLACE THE SENSOR PCB	P02

1. PART LIST

NO	ITEM	Q'TY	SPEC	CODE NO	PICTURE
1	SENSOR_T PCB ASS'Y [light emitting part]	1	KEL5008A / 560Ω	AAV20PCB011	
2	SENSOR_R PCB ASS'Y [light receiver part] * replace as needed	1	-	MEIFOPAR014	

2. How to replace the SENSOR PCB

1. REAR DOOR using 7001 key open the door.

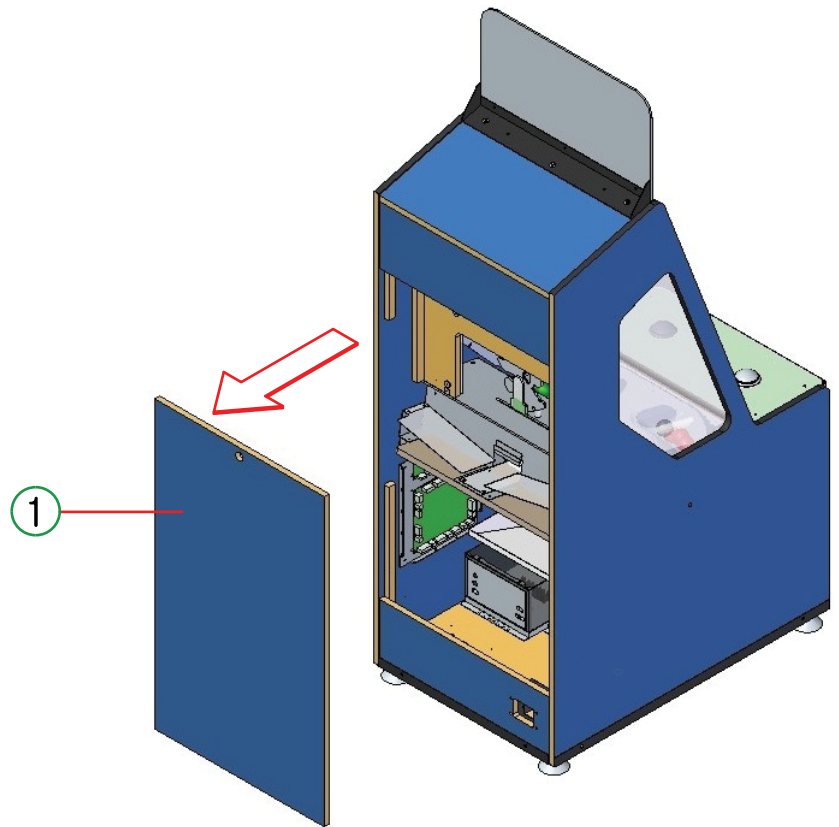

2. ① Separate the BALL BUFFER PLATE_2EA [M4 Bolt, 4EA].

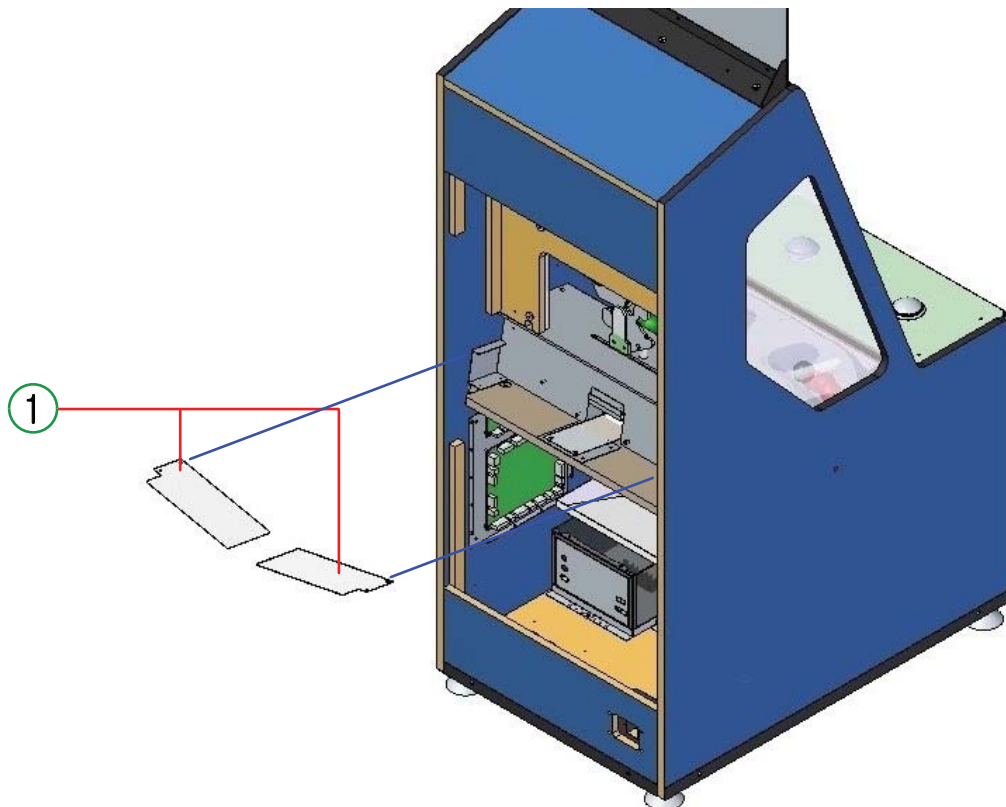

3. ① GOALKEEPER & ② GOALKEEPER FIX ACRYL [M4 Bolt, 3EA] from the rear of the case isolate.

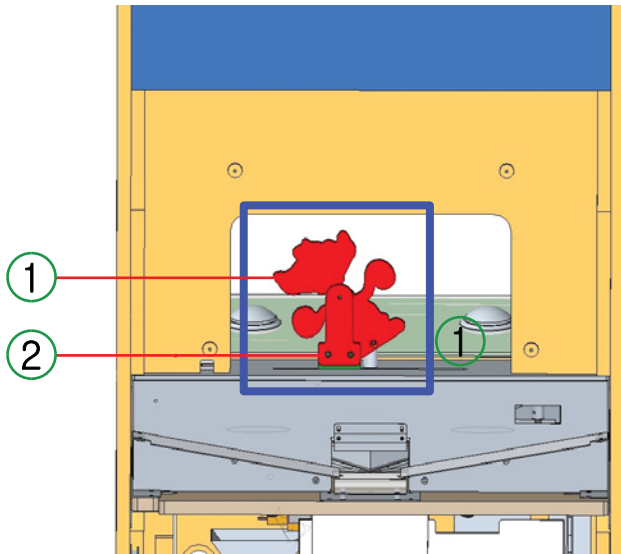

4. The bolts of ① SOLENOID PL BKT2 L,R [M6 Bolt, 2EA], which is the support of PLAYFIELD PART, and disconnect ② all connectors on the left side from the rear.

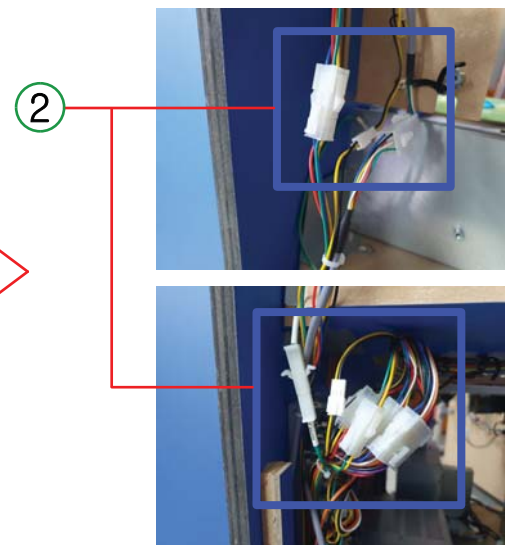
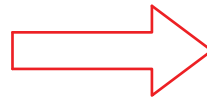
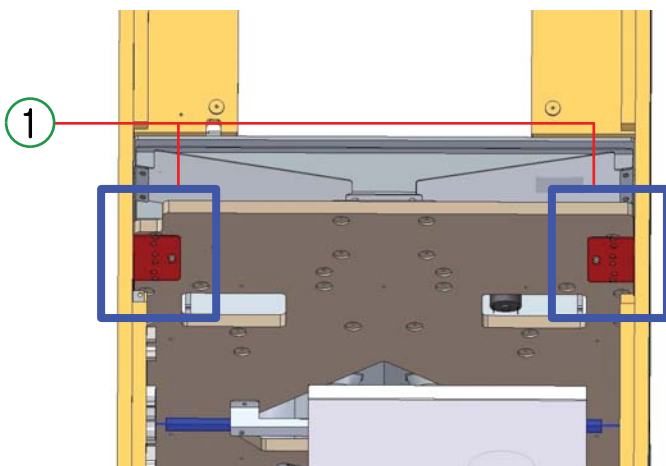

5. FRONT GLASS DOOR
Open the door using the 7001 key.

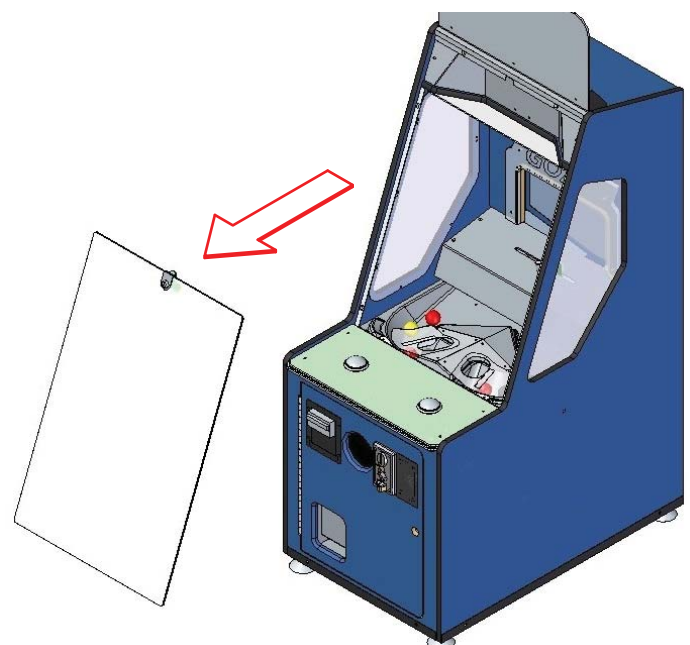

6. ① Separate the MAIN CABINET TABLE SUPT PANEL [M6 Bolt, 2EA].

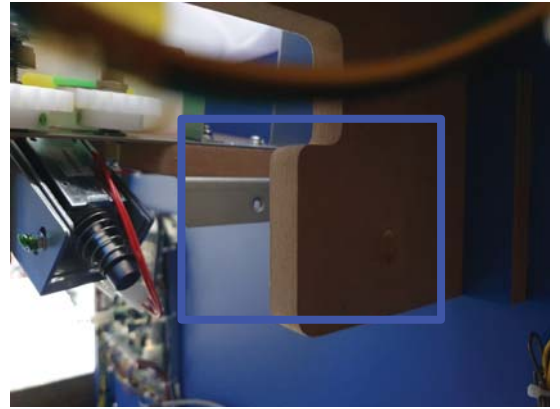
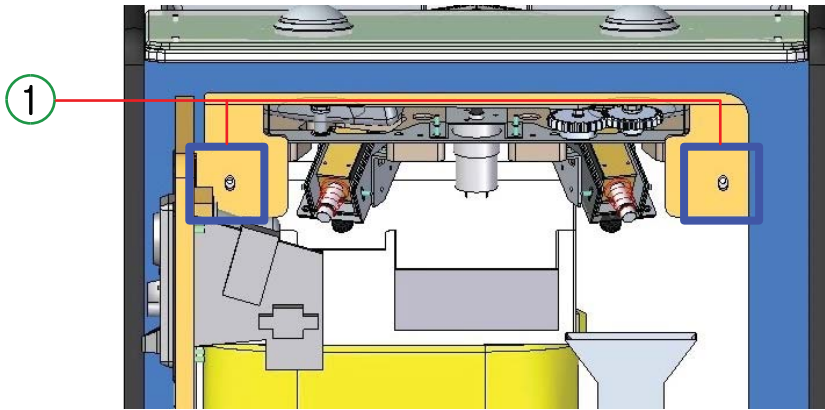

7. ① Separate the MOLD PRESS BKT [M4 Bolt, 3EA].

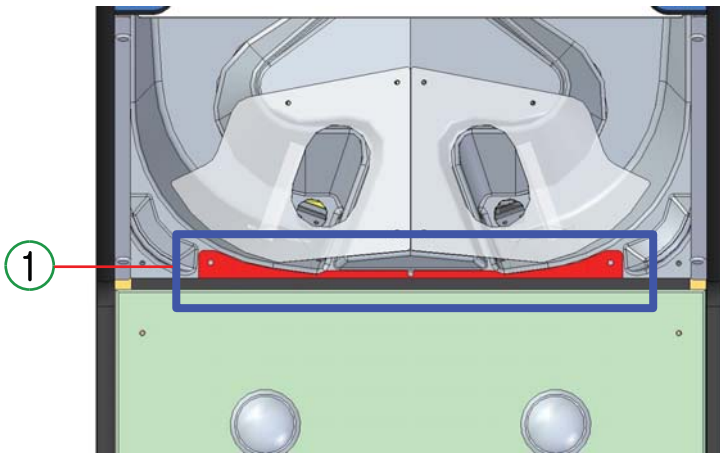

After that, ② push the PLAY FIELD PART toward the rear.

*** As shown in the picture, push only halfway where the top acrylic can be separated.**

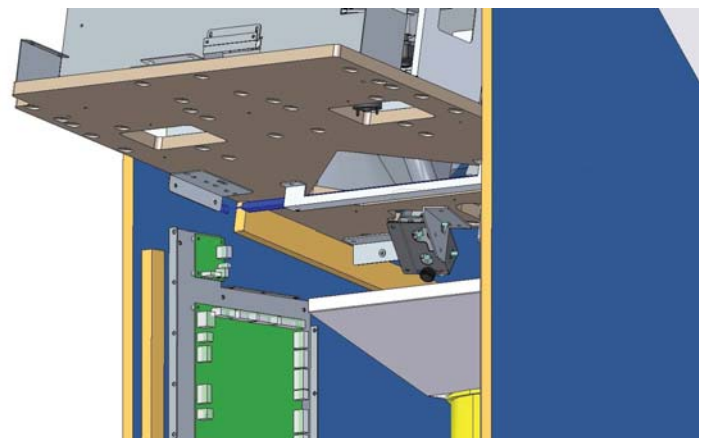
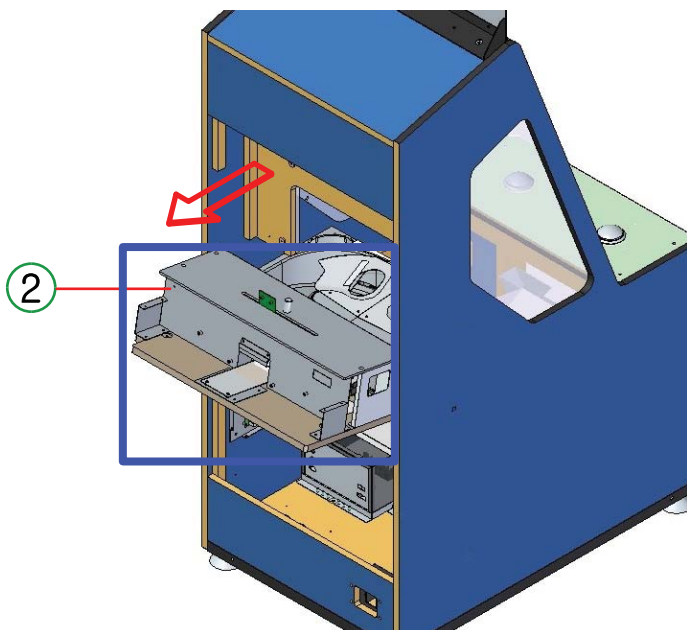

8. ① Separate the PLAYFIELD UPPER ACRYL [M4 Bolt, 4EA].

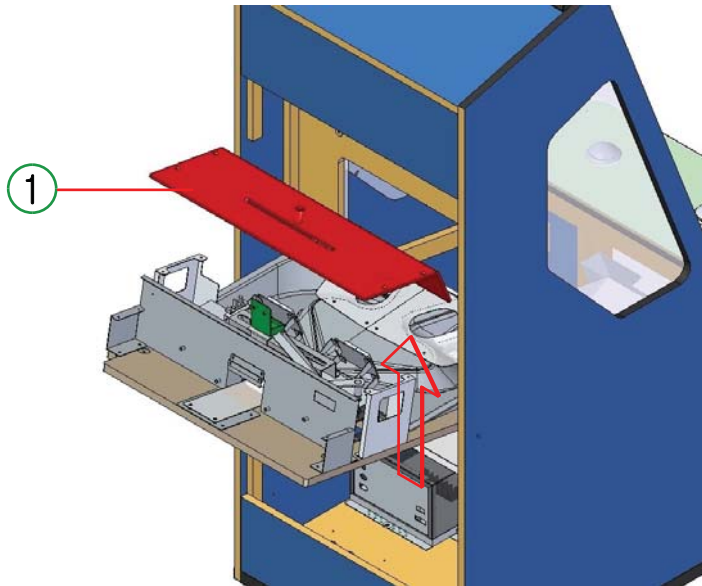

9. ① Remove the GOAL IN BALL BLOCK BKT [M4 Bolt, 4EA]. * Using electric long TIP

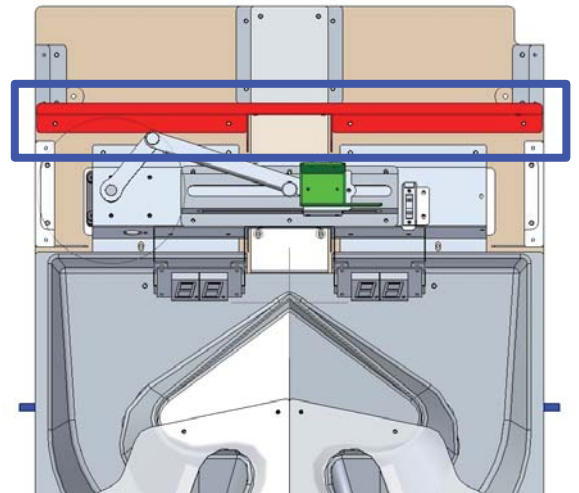
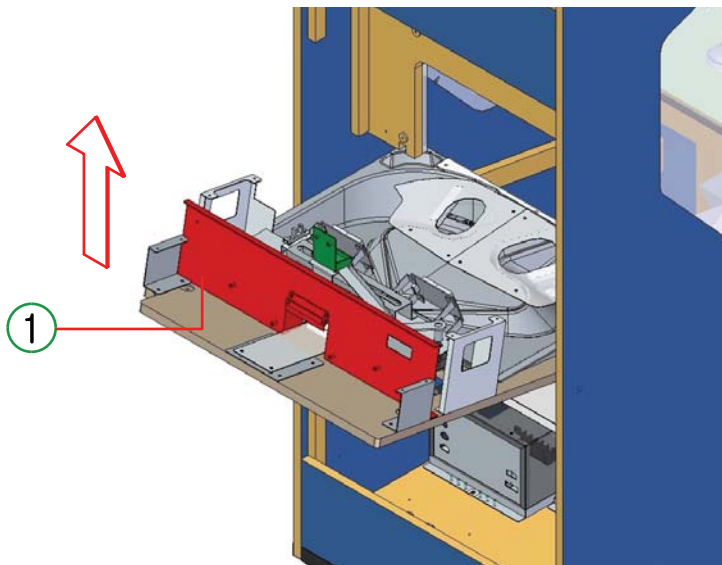

10. ① GOAL SENSOR PCB BKT L, R ASS'Y
Disconnect the connector.

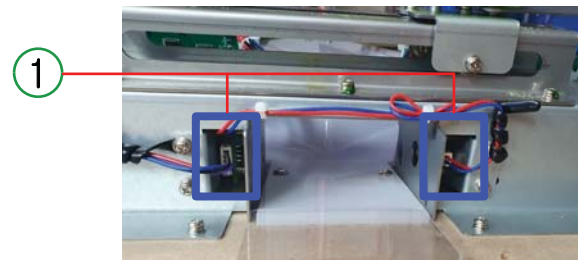

② Separate the GOAL SENSOR PCB BKT L, R [M4 Bolt, 4EA].

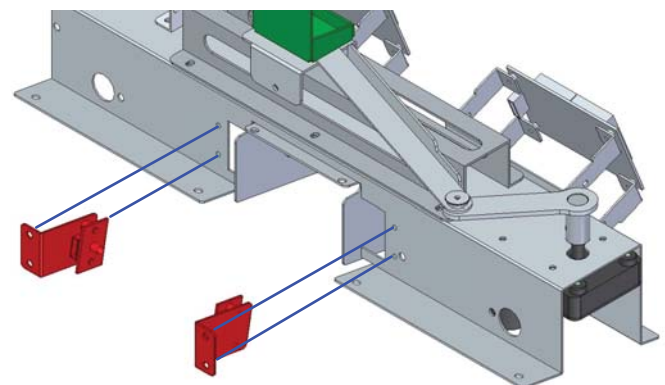
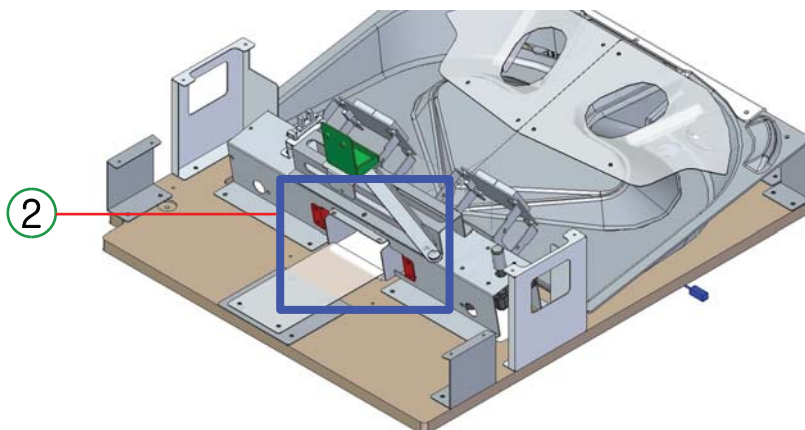

11. ① Separate the SENSOR_T PCB ASS'Y [M3 Bolt, 2EA].

* If necessary, ② replace the SENSOR_R PCB ASS'Y [light receiver].

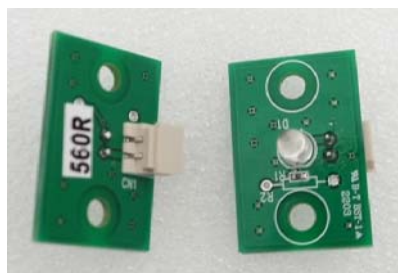

SENSOR_T PCB ASS'Y
[light emitting part]
[AAV20PCB011]

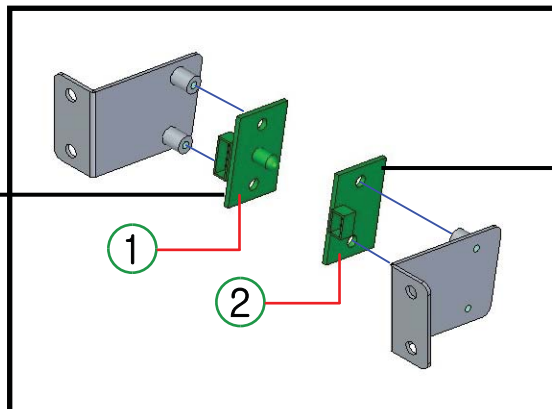

SENSOR_R PCB ASS'Y
[light receiver part]
[MEIFOPAR014]

12. After replacing the sensor PCB, assemble in the reverse order of disassembly.