

Affected Game(s): Avengers 2P and 1P CARD models.

For product reliability and safety, be careful not place coins, other objects or foreign substances on wiring or exposed PCB.

1. LIST OF MATERIALS REQUIRED FOR 1 SET

NO.	ITEM	QTY	SPEC	CODE NO.
1	LED PCB COVER	2	 (mm)	MAV20ACR070

2. SEQUENCE OF WORK

- A) Turn off power and use 7001 key (or your replacement key) to open cabinet door.
- B) After removing the connector, separate the ① LED PCB ASS'Y.*
 Assemble the supplied ② LED PCB COVER by placing it on top of the PCB as show in picture.

*Disassembled bolts are reused.



The side with narrow distance from hole is inside case

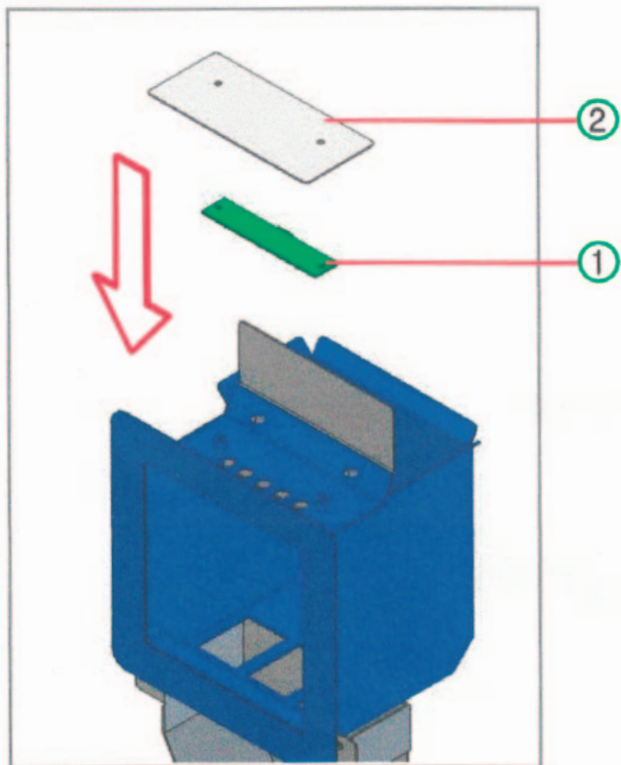

Before installation »

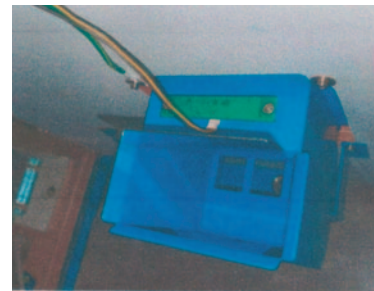

After installation »



QUESTIONS? Email service@andamirousa.com or parts@andamirousa.com